

Accis^{Pro}

Product

Catalogue 20



ITO
Design

Designer

Accis^{Pro} is the latest
collection by ITO Design.



Designer
Christopher Schmidt
ITO Design

06	What is so special?
08	Our idea
11	Design
15	Technology
16	Safety
20	Technical information
22	Configure your product
24	Profim and the Environment
25	Product Environmental Information
26	Measurements

Accis Pro





What is so special?

The chair follows your body movements.

This is unique because it supports your spine, not just while you relax but also when you move. This is what we call “active seating”. When you want to reach for something, or make an involuntary movement, Accis^{Pro} adjusts to your posture. It moves in tune with your body.



Our idea

For you to feel stable and comfortable while using the chair. This was our goal.

The distinctive feature of Accis^{Pro} is the independent movement of the backrest, seat and armrests (SmartHPS system). You can, for example, recline back and lean sideways at the same time, to reach a low cabinet or something on the floor. You can sway, activating your back and hips, as the backrest and seat work independently.



This is also the case with the armrests. They support you during involuntary movements, but they also work separately. You can position them to suit your forearms thanks to the full adjustment option (up-down, forward-backward, side-to-side and rotation).





A light and elegant form,
one that perfectly blends into
modern office spaces, without
dominating the other furniture.

We believe that technologically advanced chairs do not have to resemble racing seats. Even the adjusters can be light, without dominating the whole design. Our armchair is distinguished by its beautiful backrest profile and lightweight mesh fabric. Even when you use many Accis^{Pro} chairs close together, the space remains open and clear.



profim



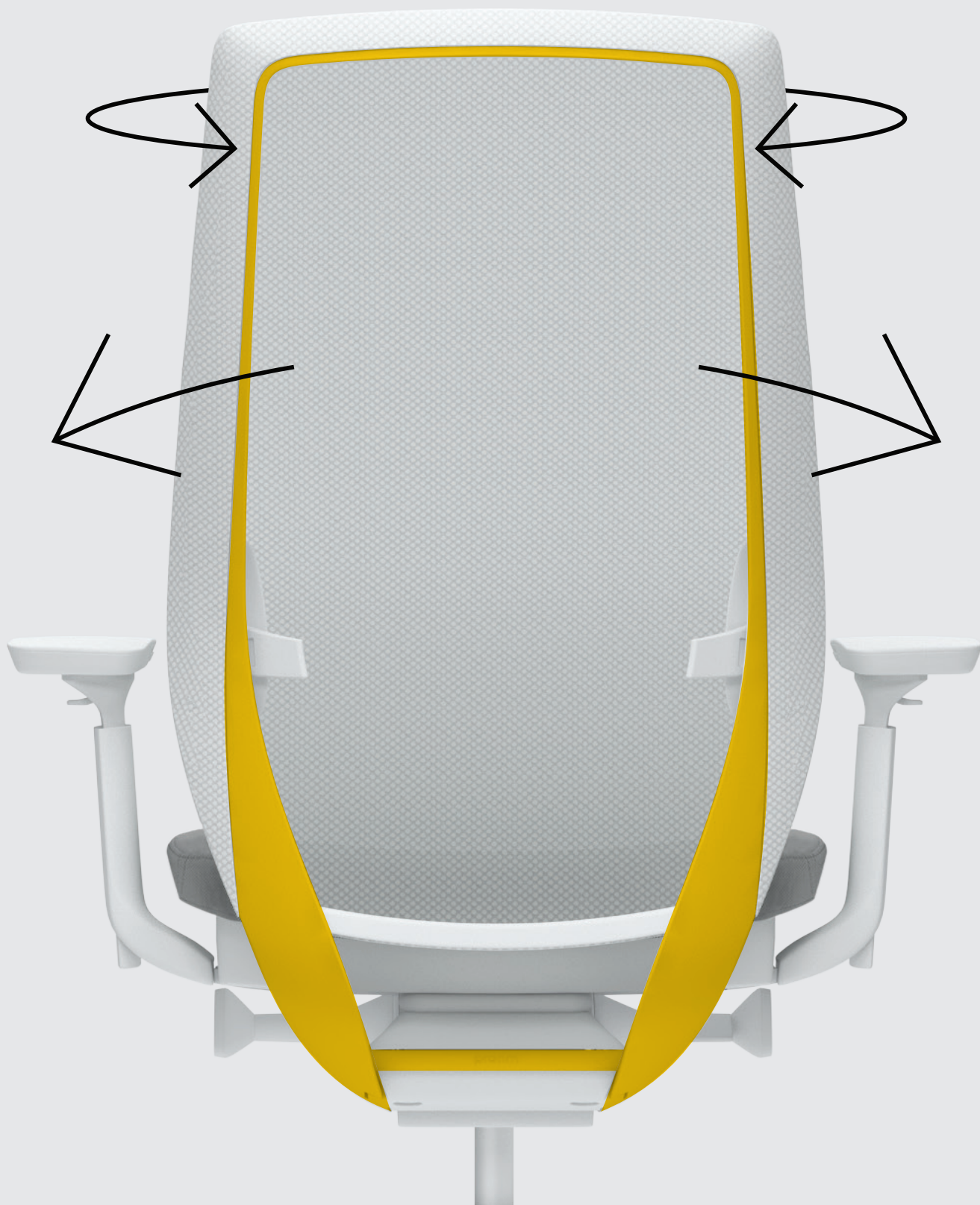

Accis^{Pro} is well-considered, right from the design stage.

Side movement of the backrest is achieved by a system of sphere-joints connected to the chair mechanism. The backrest returns to its original position thanks to a special composite rod that acts as a classic spring.

The frame is partly constructed of an elastic material, so that the backrest does not pinch you in the back when you move sideways. Movement of the seat is possible thanks to the sphere-joint in the central part of the seat.

Safety

Accis^{Pro}
means safety.



We make great efforts to ensure your safety, designing the chair to ensure that none of the gaps between the moving parts are wider than 5 mm.

Whenever this is not possible, we use special covers.







Technical information

- 1 Mesh backrest (frame made of polyamide with glass fibre) enabling free air circulation while sitting.
Mesh types: Runner i Rhythm.
 Option: height adjustable lumbar support with 2-stage depth adjustment.

- 2 Seat with side movement function, with possibility of blocking.
Foam density 75 kg/m³

- 3 Synchro mechanism with additional features:
 seat depth adjustment
 forward seat tilt

- 4 Gaslift with cushion improving sitting comfort.

- 5 5-star base
 polyamide or aluminium

- 6 Castors hard or soft, with a brake.
 Option: teflon glides, always black.

Height adjustable
armrest

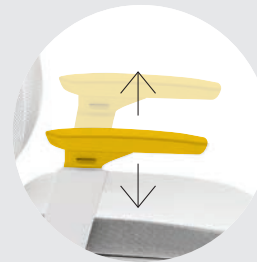

100 mm

Pivot option



+/- 27°

Span option



+/- 27 mm

Sliding pad



50 mm



Configure your product

When ordering, please use code symbols.

Accis^{Pro}

Backrest



150

Mechanism



SFL

Adjustment of seat height (130 mm).
Synchronising mechanism with the possibility to adjust the resilience of the seat / backrest to the weight of the sitting person, sliding seat, additional seat forward tilt, seat side-movement function.

Base colour¹



black²



RAL 7047

light grey²



RAL 9016

white³



graphite³



polished aluminium

¹ Plastic colours:

- bases: black/graphite/polished aluminium
- plastics always black,
- bases: lightgrey/white - plastics always lightgrey.

Plastic elements: seat cover+adjustments levers, armrests, backrest frame, lumbar support, castors.

² Polyamide

³ Aluminium

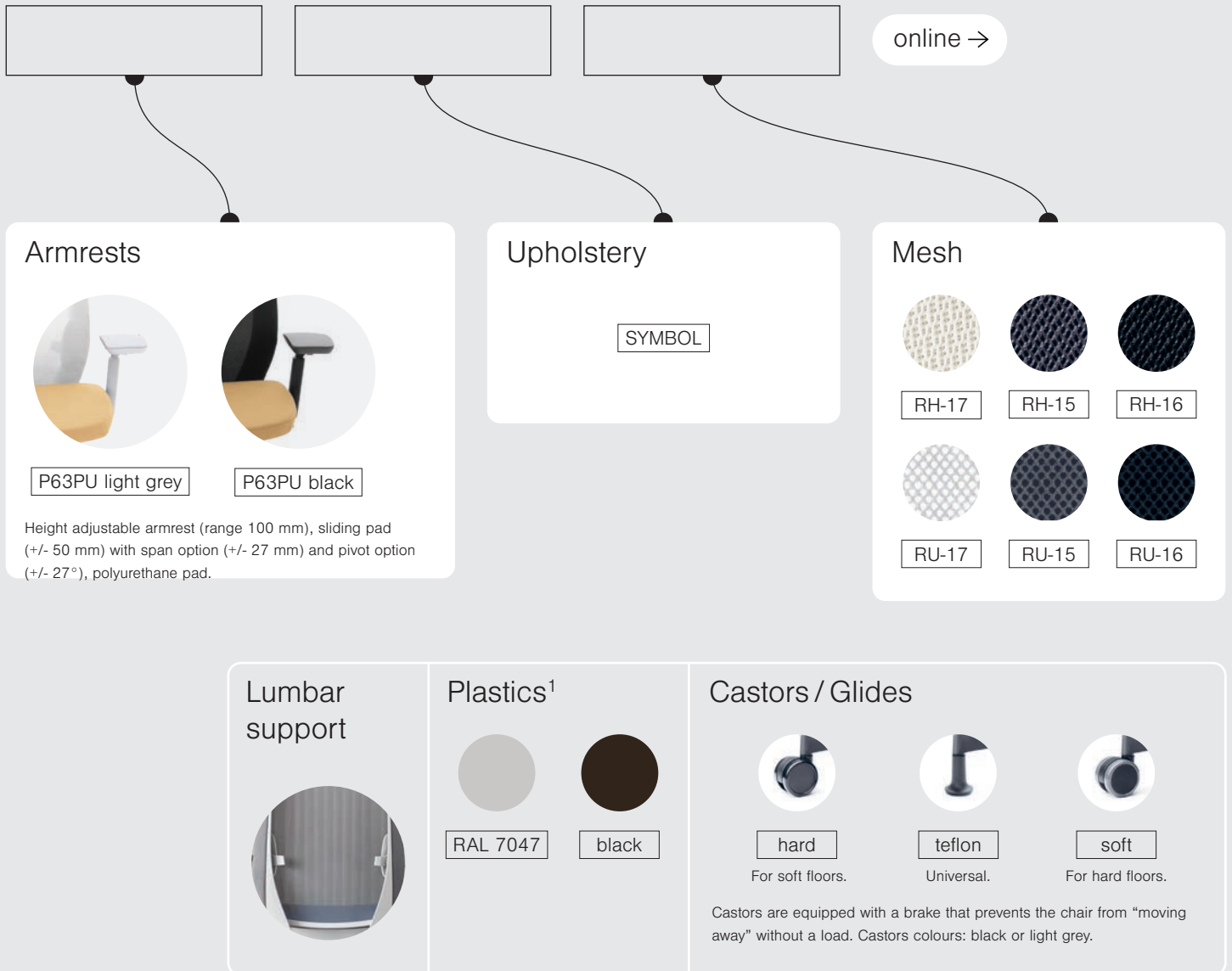

Profim and the Environment



In our operation we follow the sustainability principle. We operate in a responsible manner for the benefit of our customers, employees, suppliers, and the local community, but we always respect the environment.

In order to achieve our goals, we have implemented Environmental Management System based on the ISO 14001 standard, which allows for a comprehensive approach to ecology. We take into consideration and evaluate the way Violle products affect the environment during their entire life cycle..

Product Environmental Information

for Accis^{Pro} 150SFL P63PU

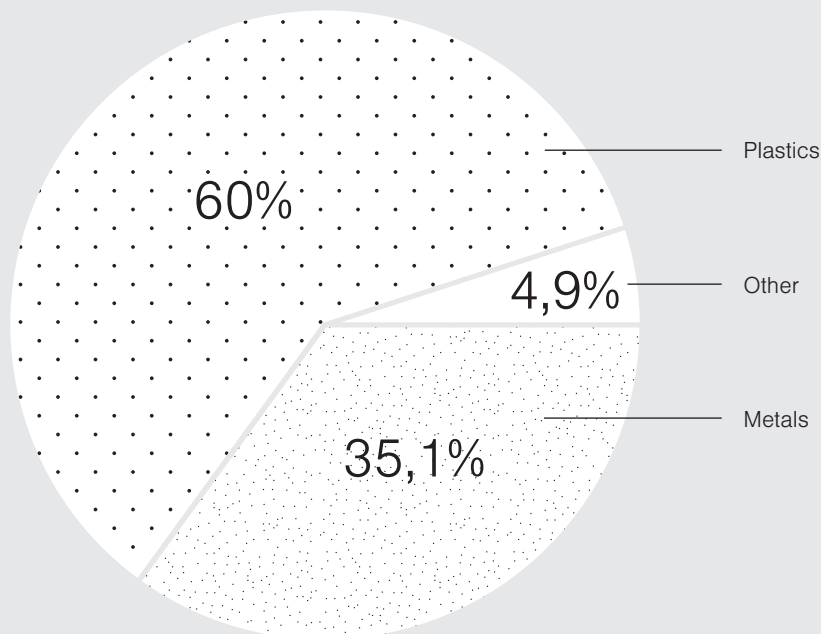

Materials used:

Metals	kg	%
Steel	5.93	34.4
Aluminium	0.11	0.7
Plastics	kg	%
Plastic	10.35	60.0
Other	kg	%
Upholstery	0.48	2.8
Foam (PU)	0.36	2.1
Weight	17.23	100

Recyclable content:

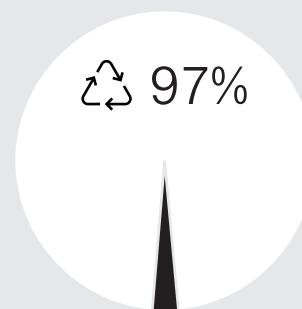

This product contains no chemical compounds harmful to human health or the environment (including PVC, chromium (VI), mercury or lead).

Measurements

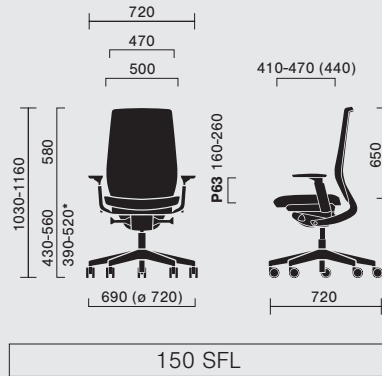

The measurements are approximate and can differ depending on the product configuration.

Measuring methodology is available at this link:
www.profim.eu/Measuring_methodology.pdf



* Seat height is measured according to PN EN 1335-1 norm (with seat burden).



The producer reserves the right to conduct construction changes and improvements of the products. Colours presented in the catalogue may vary from the original colours of furniture.

Social Media

Facebook

YouTube

Instagram

Pinterest

LinkedIn

Office

62-700 Turek, Poland

ul. Górnicza 8